

After-Sales Service  
WARRANTY CARD

PRODUCT INSTRUCTION OF  
LIVALL PHONE HOLDER

After-Sales Information:  
Thank you for purchasing LIVALL product, please read the following instructions for better service.  
1.This product can be replaced within three months after the date of purchase, and come with a one year warranty.  
2.Damages caused by the following reasons are not included in the scope of free warranty:  
•Exceeding the specified warranty period;  
•Damages caused by failure to follow the operating instructions;  
•Damages caused by unauthorized disassemble or maintenance by users or other man-made damages.  
3.This warranty card is the important certificate for the warranty service provided to the end user, please keep it well. The card should be taken along with the product to the manufacturer when the maintenance is required.  
4.Our company reserves the rights to modification and explanation for above terms and conditions.  
For more information, please visit [www.livall.com](http://www.livall.com).

User Name: \_\_\_\_\_  
Tel.: \_\_\_\_\_  
ID No.: \_\_\_\_\_  
Home Address: \_\_\_\_\_  
Seller: \_\_\_\_\_  
Purchase Date: \_\_\_\_\_  
Maintenance Record: \_\_\_\_\_

Note: This form should be completed in real details; otherwise, it would be invalid.

Thanks for choosing LIVALL phone holder. Please read the instructions carefully before use to ensure safe and satisfactory operation of this product. Please retain these instructions for further reference.

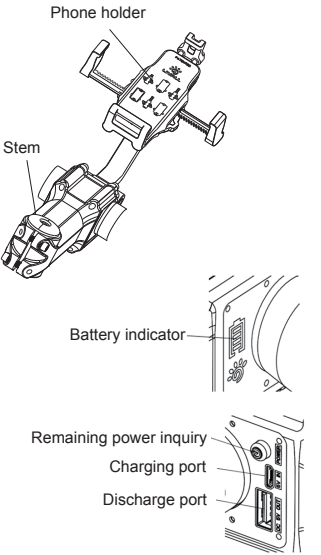

I.INSTALL S2

Remove the original stem and replace it with LIVALL S2 holder.

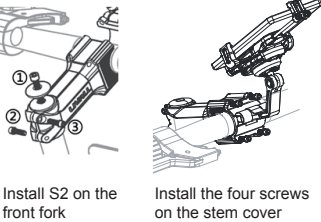
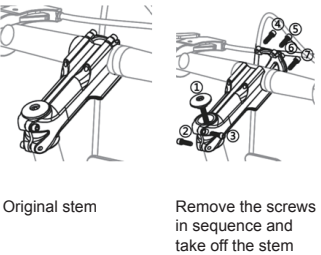

II.INSTALL H2

Remove the two screws on the top of the original stem and install LIVALL H2 phone holder.

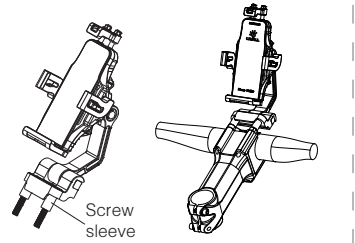

III.ADJUST THE ANGLE OF THE PHONE

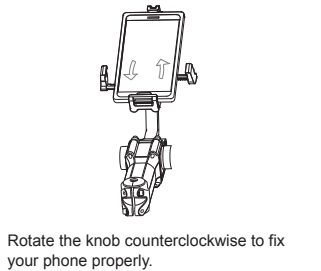
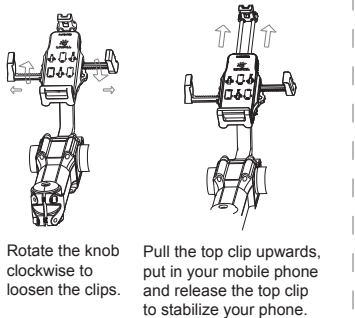



IV.CHARGE THE PHONE WITH S2

Connect the device to be charged to the USB port  by a USB cable. During discharging, the remaining power would be displayed.

V.CHARGE S2

Use a Micro USB cable to connect the  port to a USB charger with safety approvals such as CCC or UL. The charging power would be on display during charging.

VI.CHECK S2 POWER

Press the power button  to check the remaining power, which is displayed by the icon .

VII.PRODUCT SPECIFICATIONS

Applicable phone size: 4-6 inches  
Rotating angle of phone holder: 360°  
Vertical turning angle of phone holder: >200°  
Bikes applicable to H2: using M5 screws on the stem; distance between two screws: 14-34 mm.  
The following parameters apply to S2:  
Bikes applicable to S2: diameter of the central handlebar diameter: 31.8 mm; diameter of front fork stem: 28.6 mm.  
Battery capacity: 3.7V/5000MAH  
Charging port: Micro USB 5V/1A  
Charging duration: around 7h  
Output port: USB A, 5V/2A output  
Button: power checking  
Lighting indicator: four level power indication  
Stem length: 120mm  
Product size: 180\*116\*125mm

VIII.PRECAUTIONS

- 1.If the product is being used for the first time or if the product has not been used for a prolonged period, the battery may self-discharge slowly over time. Generally, it takes five to six full charge and discharge cycles for the battery maximize the performance.
- 2.Use a charger with safety approvals such as CCC or UL to charge this product.
- 3.Rough handling can cause damage to the internal precision parts and structure of the product.
- 4.Properly store this product and relevant accessories and place them out of reach of children.
- 5.It is normal for the product to get warmer during charging.
- 6.Keep the product away from fire or other heat sources to avoid danger.
- 7.Avoid contact with metal objects to the charging port or discharge port; otherwise, short circuit may occur and cause damage to the product.
- 8.Changes or unauthorized repair of the product could cause the product failing in normal use and void the warranty.



Download the app

[www.livall.com](http://www.livall.com)

LIVALL Phone Holder



Designed and Assembled in Shenzhen China

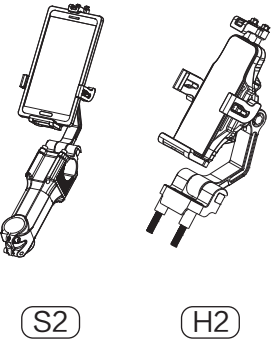

S2

H2

Phone Holder